

Plan on Type 1 Precast Step Unit
(Perpendicular Steps)

1:20

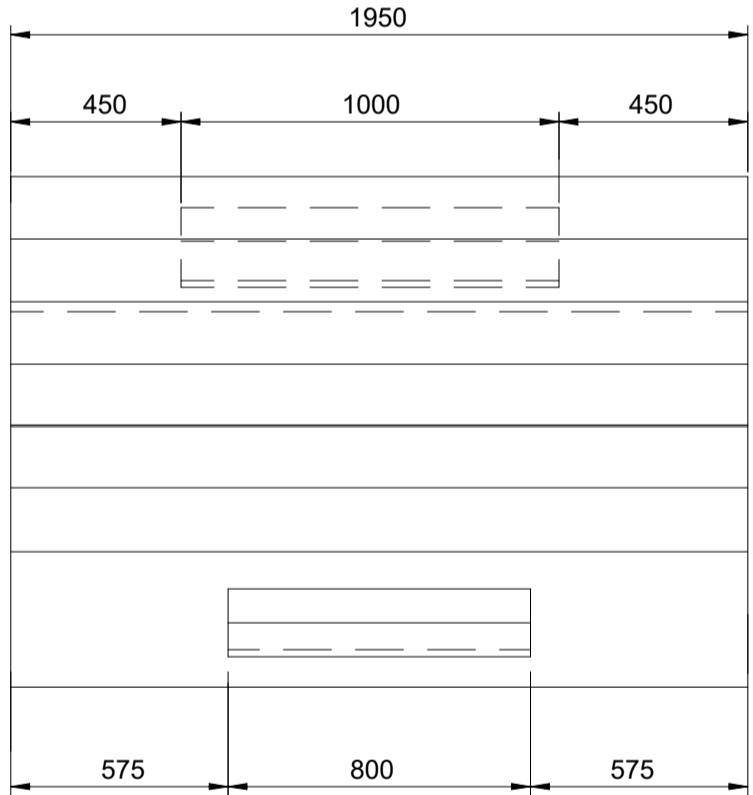

Elevation

1:20

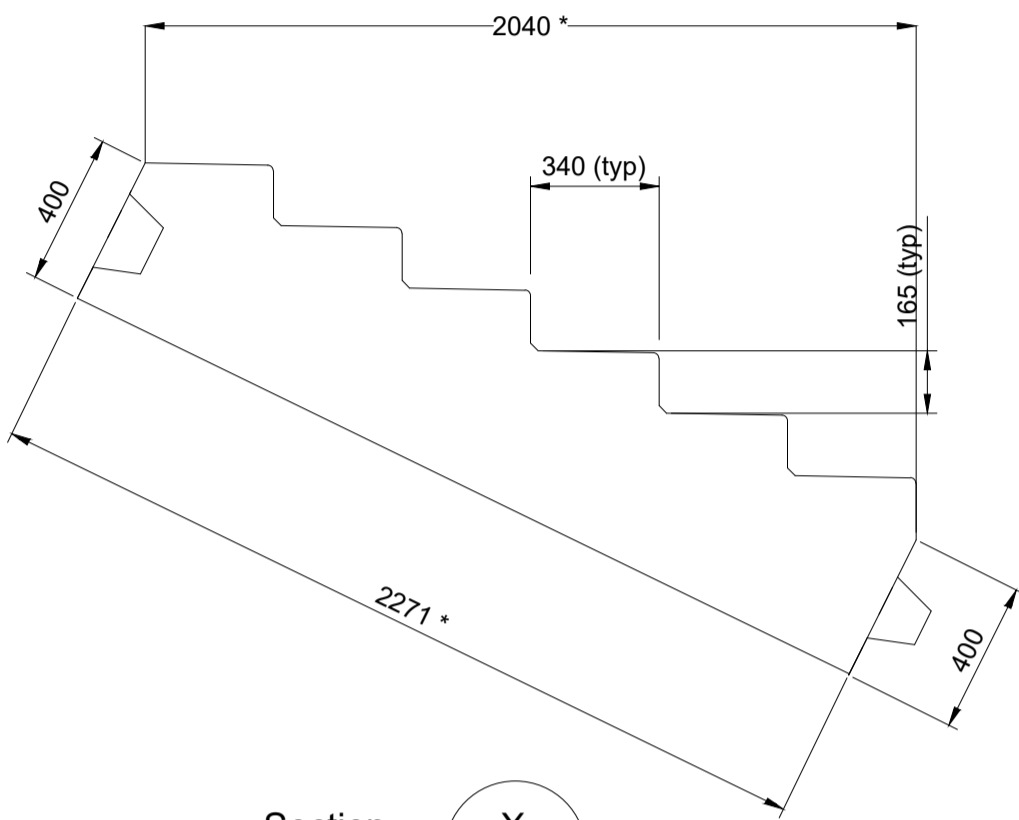
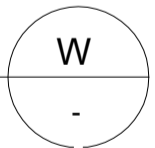

Section

1: 20

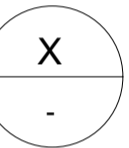

Note:

Dimension varies. Refer to drawings 3522 and 3623 for length of overall group of precast units. Contractor to determine number of treads and risers per unit to suit preferred construction methodology. For example the top and middle flights are assumed as composed of two 2040mm long precast units each. The bottom flight could be composed of either 1) one 3060mm long precasts unit or 2) One 2040mm long unit and one 1020mm long unit.

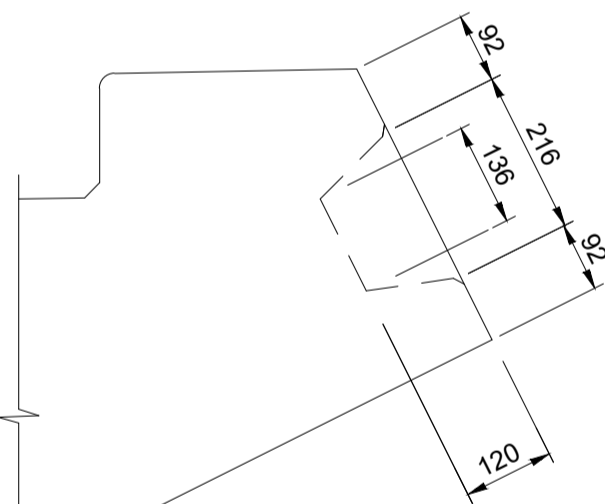

Detail

1:10

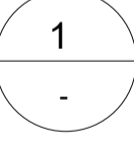

(Groove Detail)

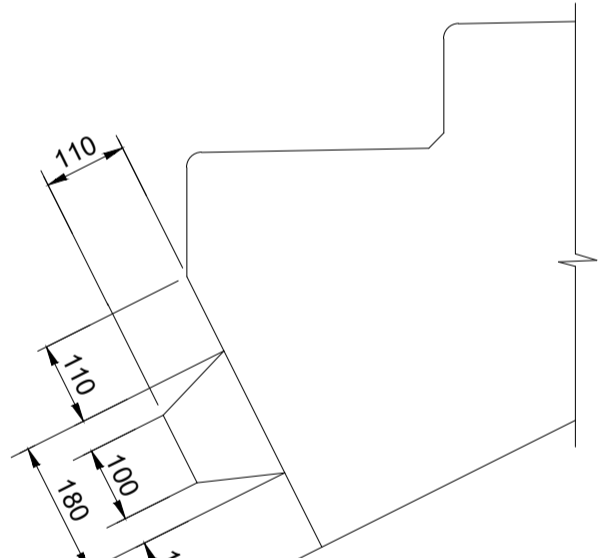

Detail

1:10

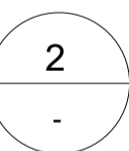

(Tongue Detail)

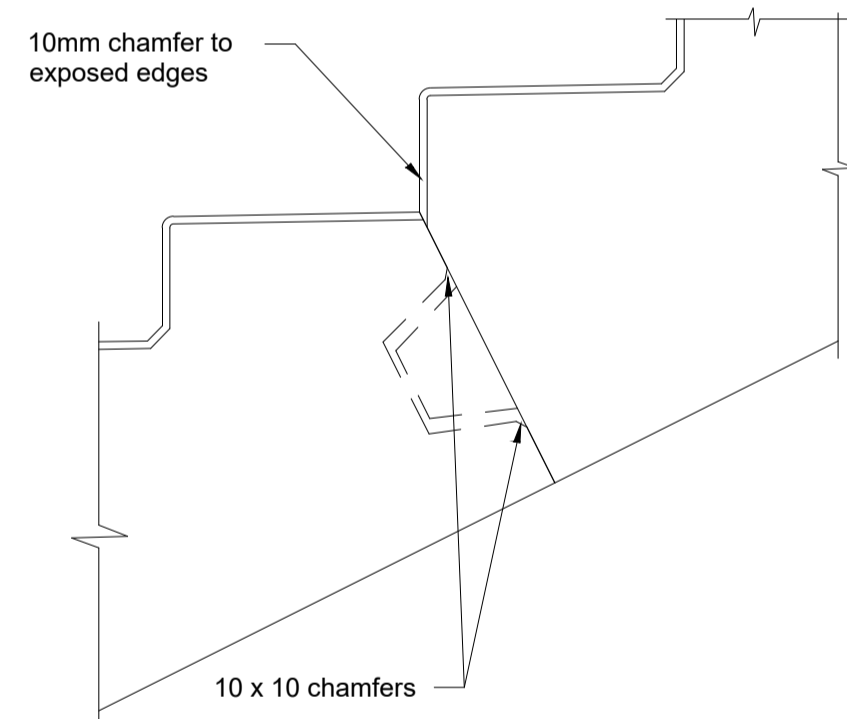

Connection Detail

1:10

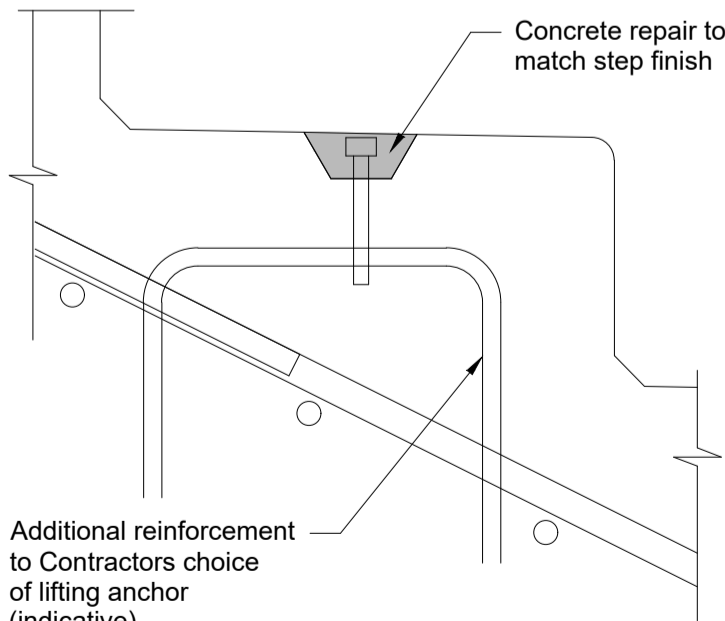

Detail

1: 5

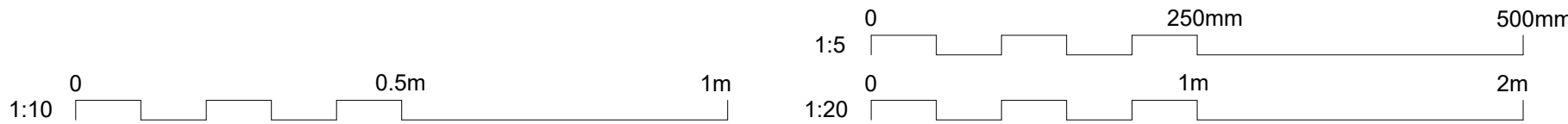
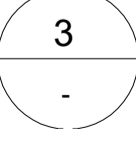

- Notes
- All dimensions are in millimetres unless noted otherwise.
 - All levels shown are in metres relative to Ordnance Datum (mOD).
 - Joint tolerances between precast units:
 - Vertical Joints $\pm 5\text{mm}$
 - Horizontal Joints $\pm 5\text{mm}$
 - Underside of precast units shall be uniformly supported and all voids grouted up. Steel packers to be provided by Contractor as necessary.
 - Thickness of grout layer to be min. depth required for flowability plus 20mm. Minimum thickness required for flowability to be demonstrated by Contractor.
 - All precast exposed edges to have 10 x 10mm chamfer unless noted otherwise.
 - Tolerances
 - Principle dimensions Length/Width $+0/-5\text{mm}$
 - Adjacent Step risers/goings/unit thickness $+5\text{mm}/-5\text{mm}$
 - Key joint $+5\text{mm}/-5\text{mm}$
 - Finishes
 - Exposed surfaces - steel formed
 - Tongues and grooves - steel formed
 - Underside/unformed face - tamped finish across slope in accordance with Specification.
 - A precast unit of six steps is shown on this drawing as an example. Refer to drawings 3522 and 3523 for number of steps and lengths of precast unit groupings. Contractor to determine number of treads and risers per unit to suit preferred construction methodology.
 - Precast units are to be detailed and scheduled by the Contractor. Refer to Appendix 1/10 of the Specification for further requirements.

Key to symbols

Reference drawings

415437-MMD-00-XX-DR-C-3500 - Coastal General Arrangement Plan
415437-MMD-00-XX-DR-C-3520 series - Sections & details
415437-MMD-00-XX-DR-C-3540 series - RC details

Rev	Date	Drawn	Description	Ch'k'd	App'd
C01	23.01.26	RW	Tender Issue	GWM	SS
P01	21.01.26	RW	Tender Issue for Client Acceptance	GWM	SS

Status Stamp

Tender Issue



First Floor, Bryn Eirias
Abergele Road
Colwyn Bay
LL29 8BY
United Kingdom
T +44 (0)1492 534601
W mottmac.com

Client



Title
**Ph.3 - Old Colwyn Promenade Coastal
Defence & Active Travel Improvements
Precast Step Type 1 Unit Details
Perpendicular Steps**

Designed	P.C.O.	Eng. Check	G. Mitchell	
Drawn	R. Williams	Coordination	G. Mitchell	
Dwg. Check	G. Mitchell	Approved	S. Smith	
MMD Project Number	415437	Scale at A1	As indicated	Security STD
Suitability Description	Tender Issue	Suit. Code	A4	
Drawing Number	415437-MMD-00-XX-DR-C-3528	Rev	C01	